

REV	DESCRIPTION	DRAWN	DATE
		APPROVED	DATE

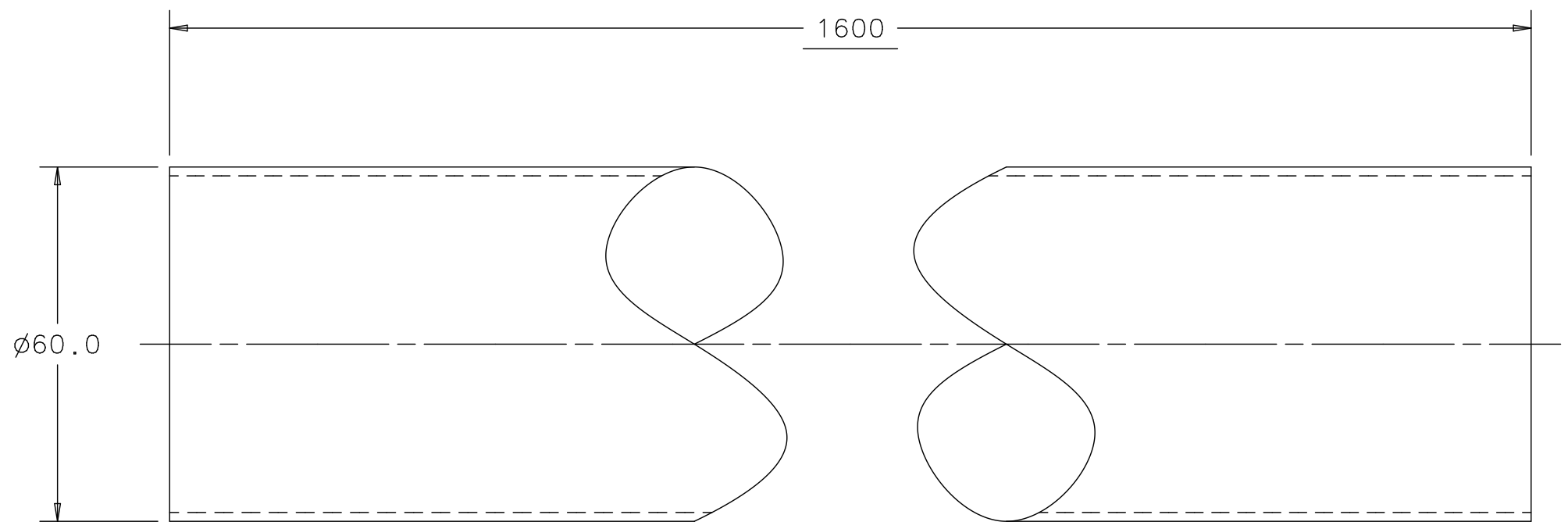
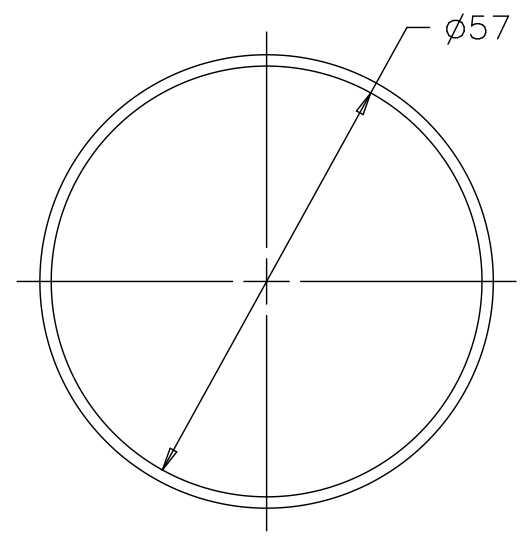
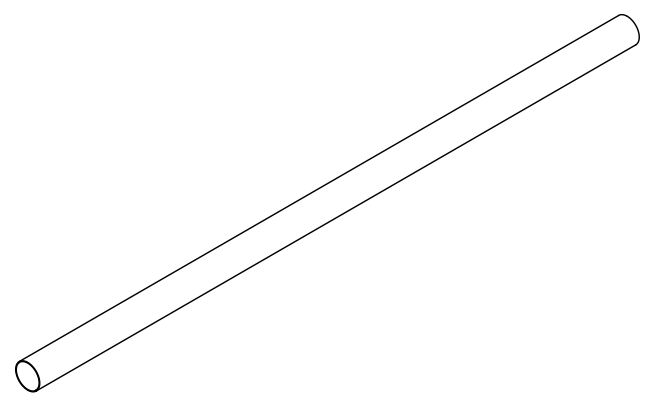

UNLESS OTHERWISE SPECIFIED			ORIGINATOR	M.MCGEE	07-AUG-2013
METRIC	X.X	ANGLES	DRAWN	R.STEWART	07-AUG-2013
$\pm 0.25$	$\pm 0.1$	$\pm .5^\circ$	CHECKED	D.SCHMITT	06-SEP-2013
1. BREAK ALL SHARP EDGES 0.4 MAX. 2. DO NOT SCALE DRAWING. 3. DIMENSIONS BASED UPON ASME Y14.5M-1994 4. MAX. ALL MACH. SURFACES 1.6 / $\sqrt{\quad}$ 5. DRAWING UNITS: METRIC			APPROVED	M.MCGEE	06-SEP-2013
			USED ON		
			MATERIAL		
			6061-T6 ALUMINUM		

**FERMI NATIONAL ACCELERATOR LABORATORY**  
 UNITED STATES DEPARTMENT OF ENERGY

**NOVA-ANU TARGET HALL**  
**MEDIUM ENERGY BAFFLE**  
**BAFFLE CORE SHELL**

SCALE	DRAWING NUMBER	SHEET	REV
1:1	8875.000-MB-433953	1 OF 1	

CREATED WITH : Ideas12NXSeries GROUP: ACCELERATOR MECH. SUPPT.