



# CAPITOL ACCESSIBILITY GUIDE

- All Capitol, Capitol Extension and Capitol Visitors Center facilities are accessible to persons with disabilities.
- For special assistance, contact the Capitol Information and Guide Service at **512.463.0063**, email: [webmaster@tspb.texas.gov](mailto:webmaster@tspb.texas.gov) or visit their office in the Capitol 1S.2, in the first floor, south wing.
- For concerns and information on accommodations for people with disabilities, please contact:
  - Senate ADA Coordinator: Delicia Sams (512) 463-0400
  - House ADA Coordinator: James Freeman (512) 463-0865
- Street parking is limited and competitive. Parking in the Visitor Parking Garage is recommended.
- Vehicles properly displaying an official disabled parking placard or disabled parking license may park at parking meters in the Capitol Complex for free at any time.
- Watch for oval-shaped signs on the Capitol Grounds which indicate accessible routes to the Capitol Visitors Center or Capitol North Entrance.

A limited number of wheelchairs can be borrowed from the Capitol

- Information and Guide Service in 1S.2 and or the Capitol Visitors Center with a photo ID during business hours (hours are subject to change). First come first served.

Visitors interested in Capitol history are encouraged to begin their tour at the Capitol Visitors Center.

- Publications are available in large print versions and Braille for the Capitol, Capitol Visitors Center and Grounds. Brochures may be checked out and returned after use from the Capitol Information and Guide Service in Capitol 1S.2. Guided tours for the Capitol, Capitol Visitors Center and Governor's Mansion using American Sign Language (ASL) interpreters can be given with 1 week's advance notice. Please call 512.305.8402 for scheduling.

# Capitol Site Map

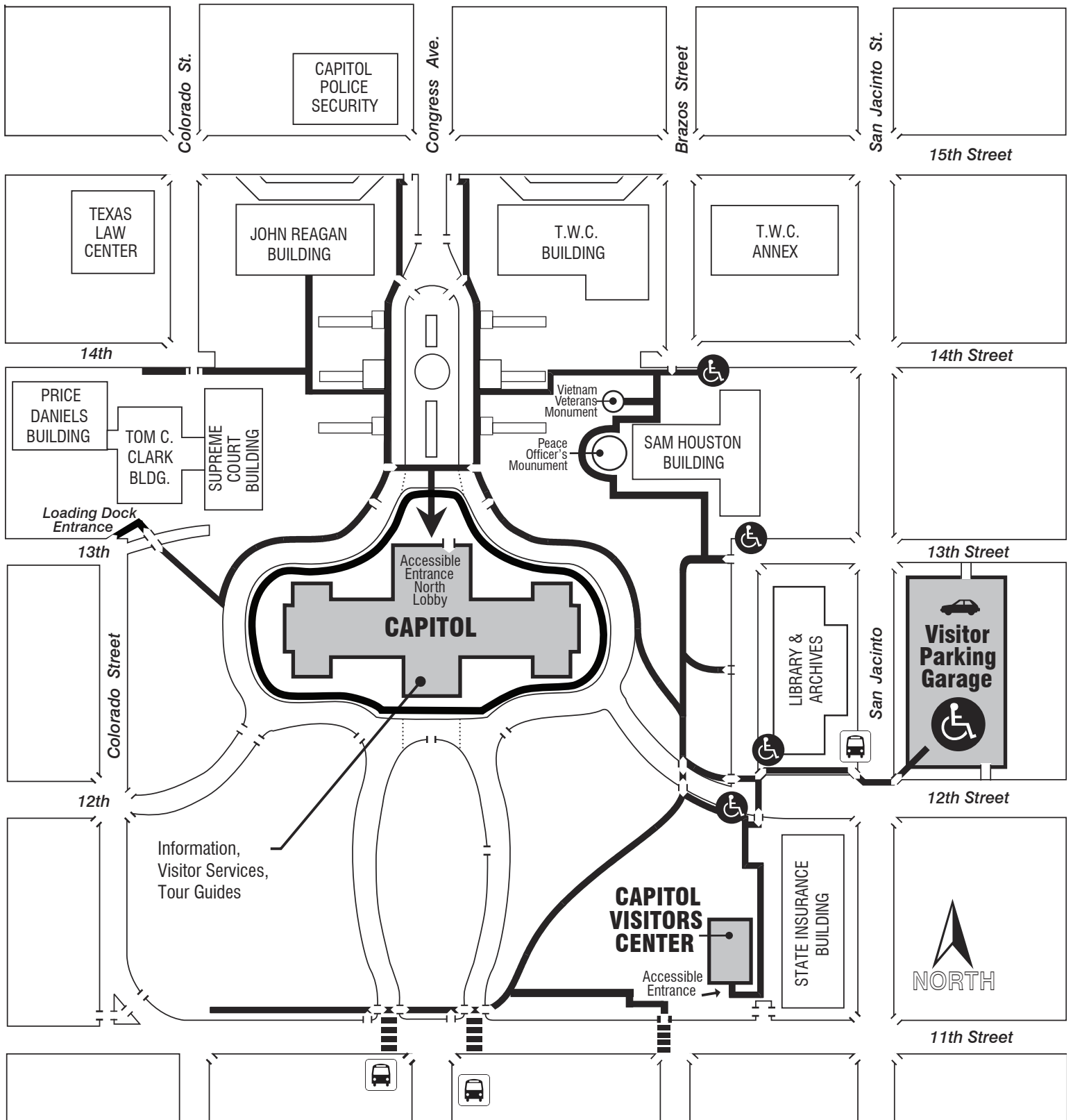

 **PRIMARY ACCESSIBLE ROUTES**

 **CURB RAMPS**

 **BUS STOP**

 **ACCESSIBLE PARKING**

# Ground Floor (Basement)

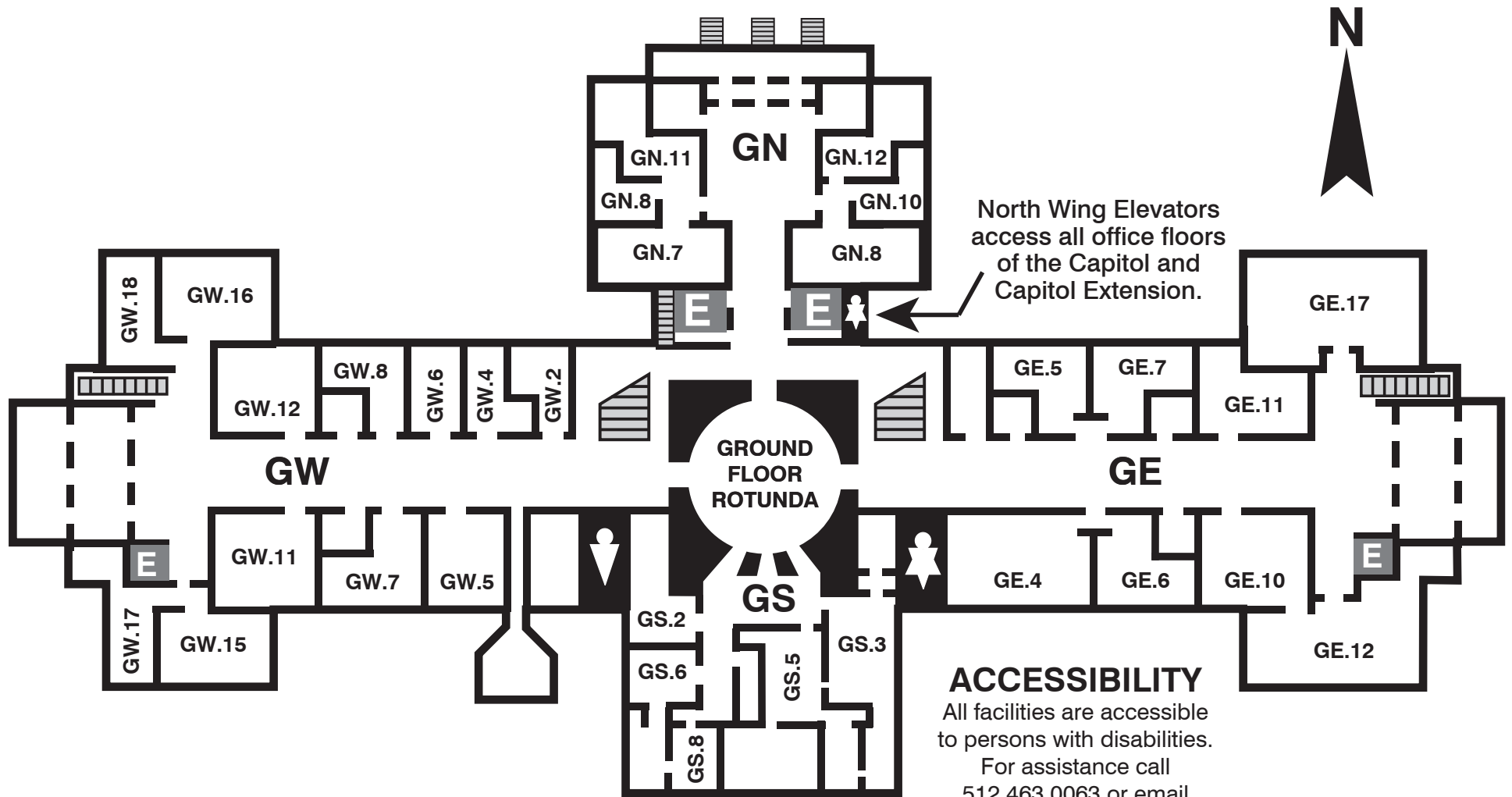

North Wing Elevators access all office floors of the Capitol and Capitol Extension.

**ACCESSIBILITY**  
All facilities are accessible to persons with disabilities.  
For assistance call 512.463.0063 or email [webmaster@tspb.texas.gov](mailto:webmaster@tspb.texas.gov).

-  **E** ELEVATOR
-  **♂** MEN'S ROOM
-  **♀** WOMEN'S ROOM
-  **STAIRS**

# First Floor

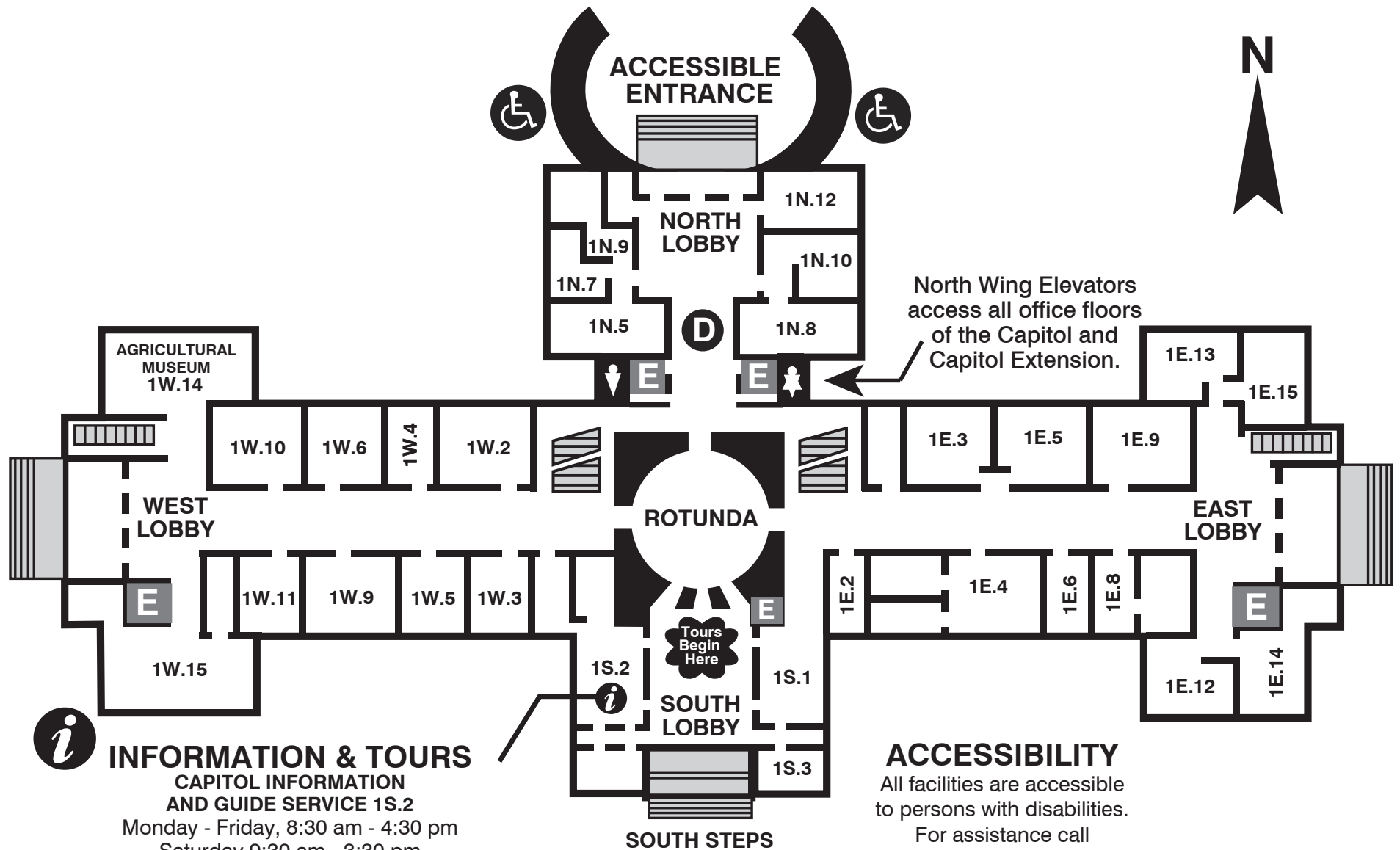

North Wing Elevators  
access all office floors  
of the Capitol and  
Capitol Extension.

 **INFORMATION & TOURS**  
**CAPITOL INFORMATION  
AND GUIDE SERVICE 1S.2**  
 Monday - Friday, 8:30 am - 4:30 pm  
 Saturday 9:30 am - 3:30 pm  
 Sunday, Noon - 3:30 pm  
 Call 512.463.0063 or email  
[webmaster@tspb.texas.gov](mailto:webmaster@tspb.texas.gov)  
 for more information.

**ACCESSIBILITY**  
 All facilities are accessible  
 to persons with disabilities.  
 For assistance call  
 512.463.0063 or email  
[webmaster@tspb.texas.gov](mailto:webmaster@tspb.texas.gov).

# Second Floor

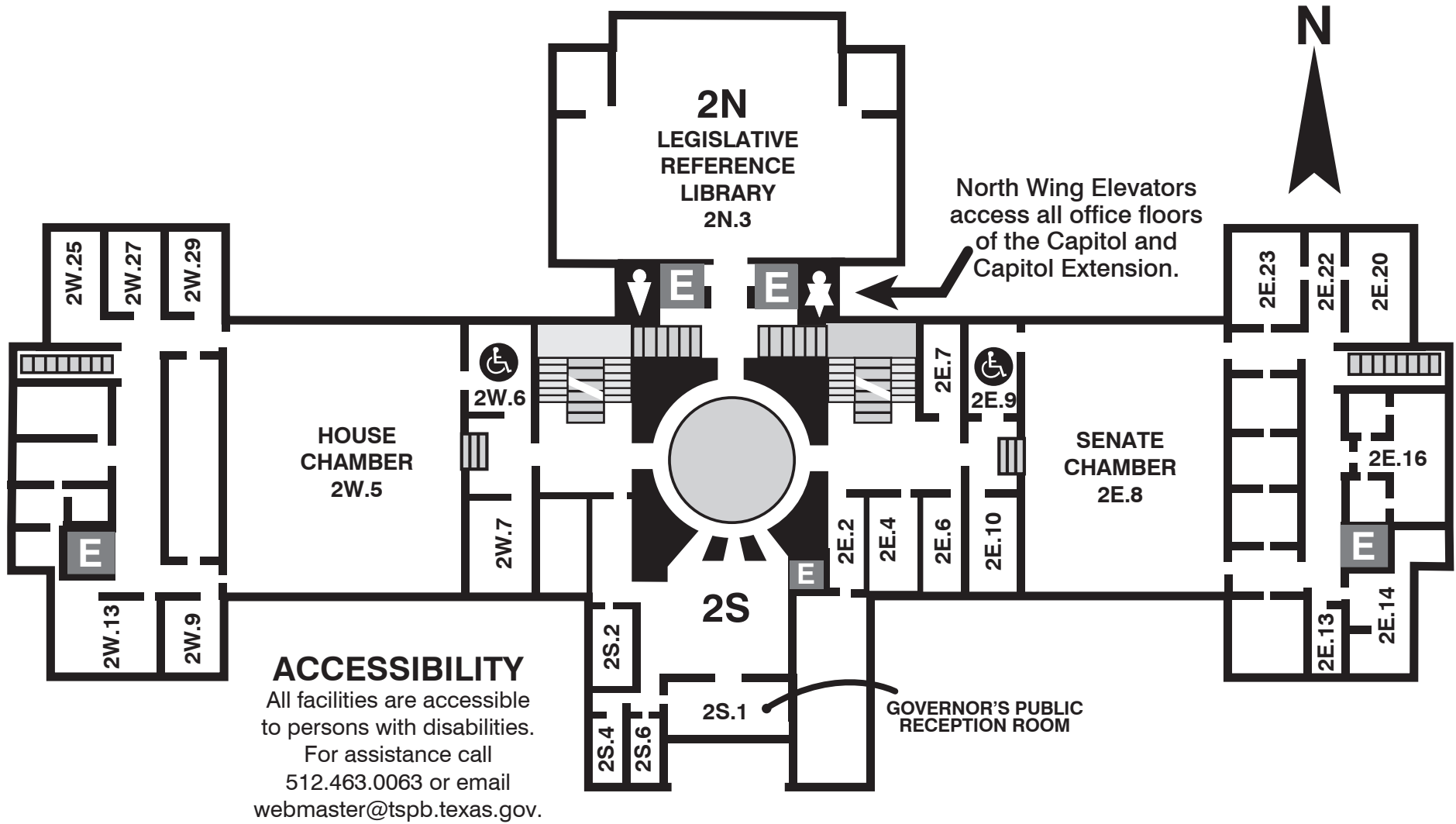

LIFT



ELEVATOR



MEN'S ROOM



WOMEN'S ROOM



STAIRS

# Third Floor

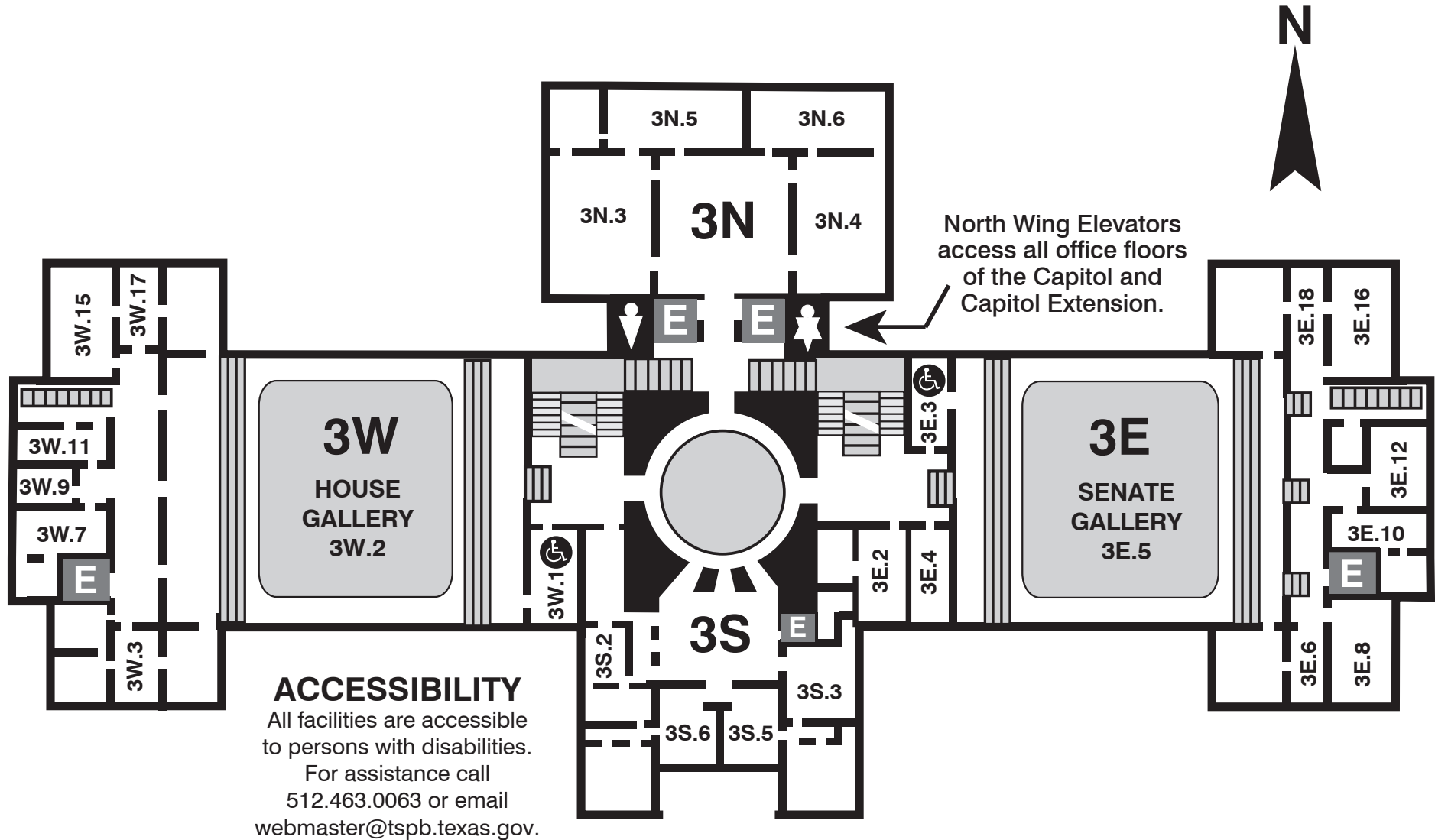

LIFT



ELEVATOR



MEN'S ROOM



WOMEN'S ROOM



STAIRS

# Fourth Floor

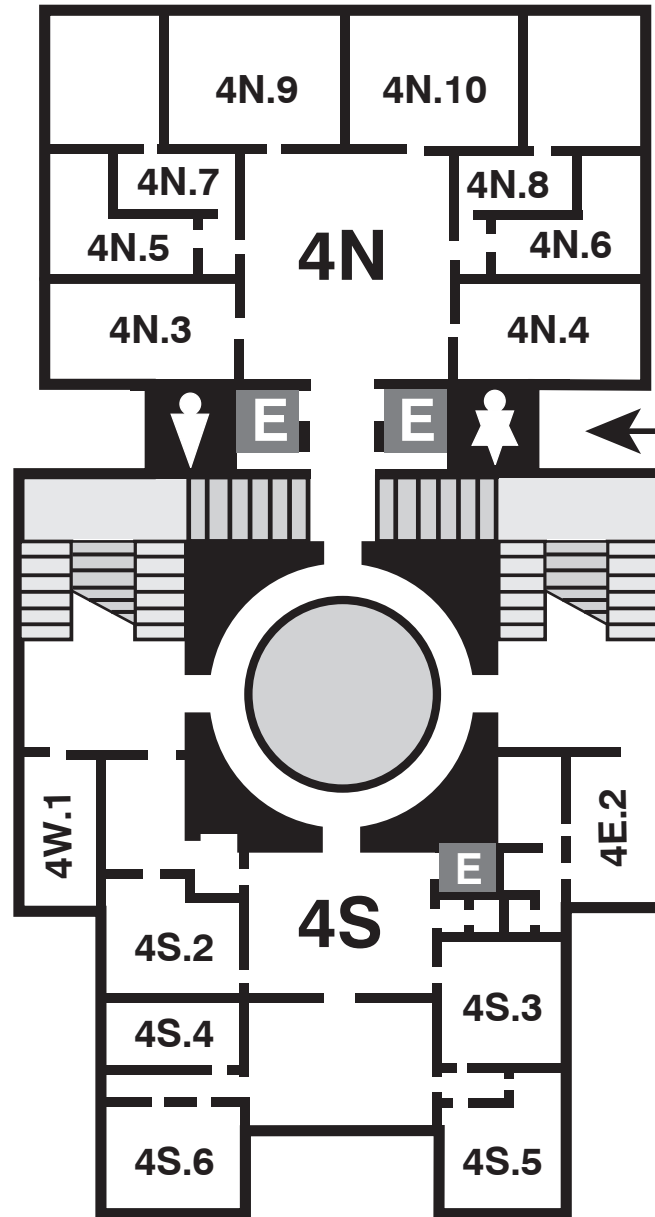

North Wing Elevators  
access all office floors  
of the Capitol and  
Capitol Extension.

## ACCESSIBILITY

All facilities are accessible  
to persons with disabilities.  
For assistance call  
512.463.0063 or email  
[webmaster@tspb.texas.gov](mailto:webmaster@tspb.texas.gov).

 **ELEVATOR**

 **MEN'S ROOM**

 **WOMEN'S ROOM**

 **STAIRS**

# Extension First Floor (E1)

JOHN H. REAGAN BUILDING TUNNEL (CARD ACCESS)

TEXAS WORKFORCE COMMISSION and ROBERT E. JOHNSON BUILDING TUNNEL (CARD ACCESS)

State Representatives: E1.200's through E1.500's

Senators: E1.600's through E1.800's

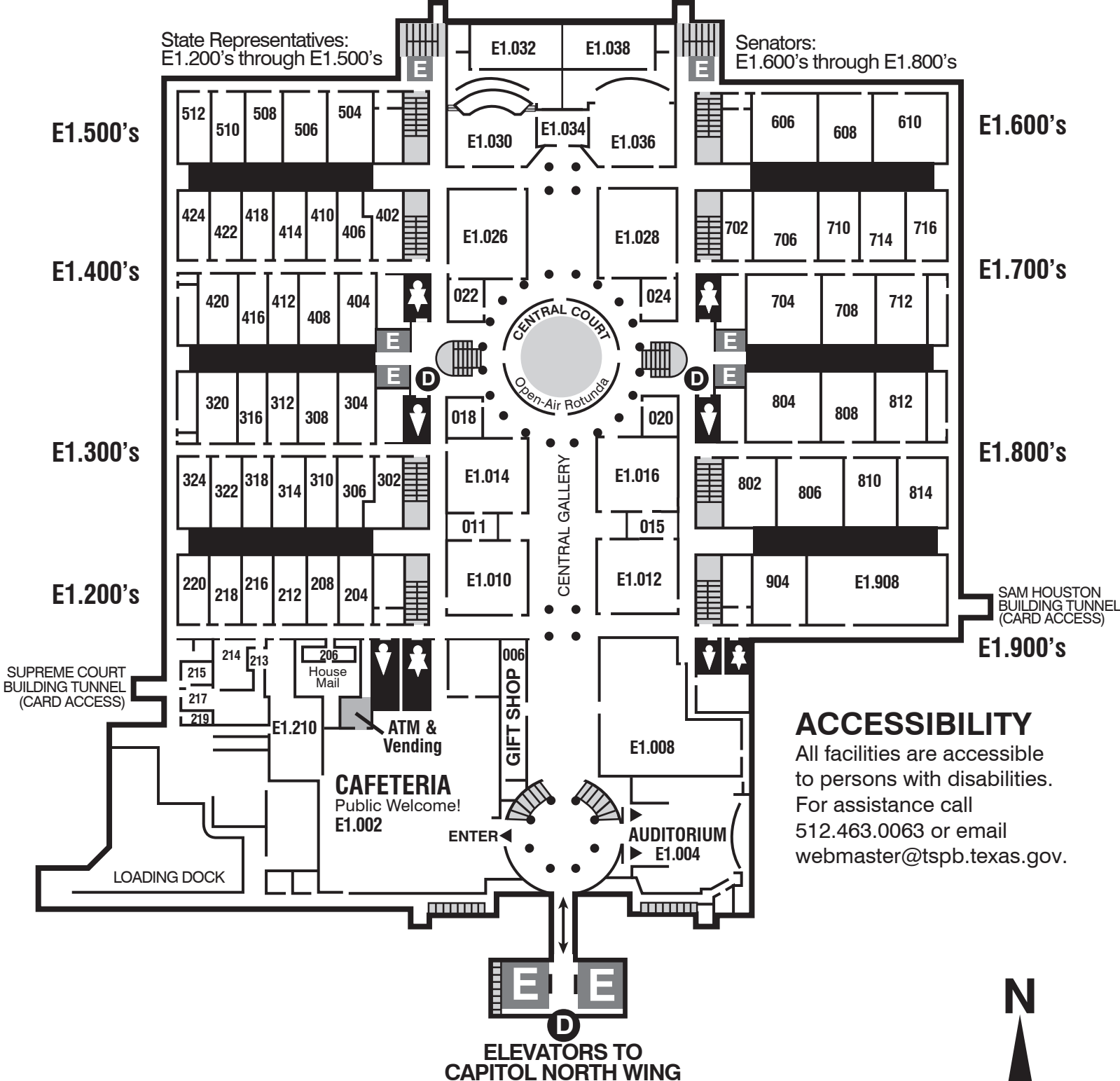

**ACCESSIBILITY**  
 All facilities are accessible to persons with disabilities. For assistance call 512.463.0063 or email [webmaster@tspb.texas.gov](mailto:webmaster@tspb.texas.gov).

 **ELEVATOR**
 **MEN'S ROOM**
 **WOMEN'S ROOM**  
 **DIRECTORY**
 **STAIRS**





# Extension Second Floor (E2)

State Representatives Offices  
E2.200 through E2.900's

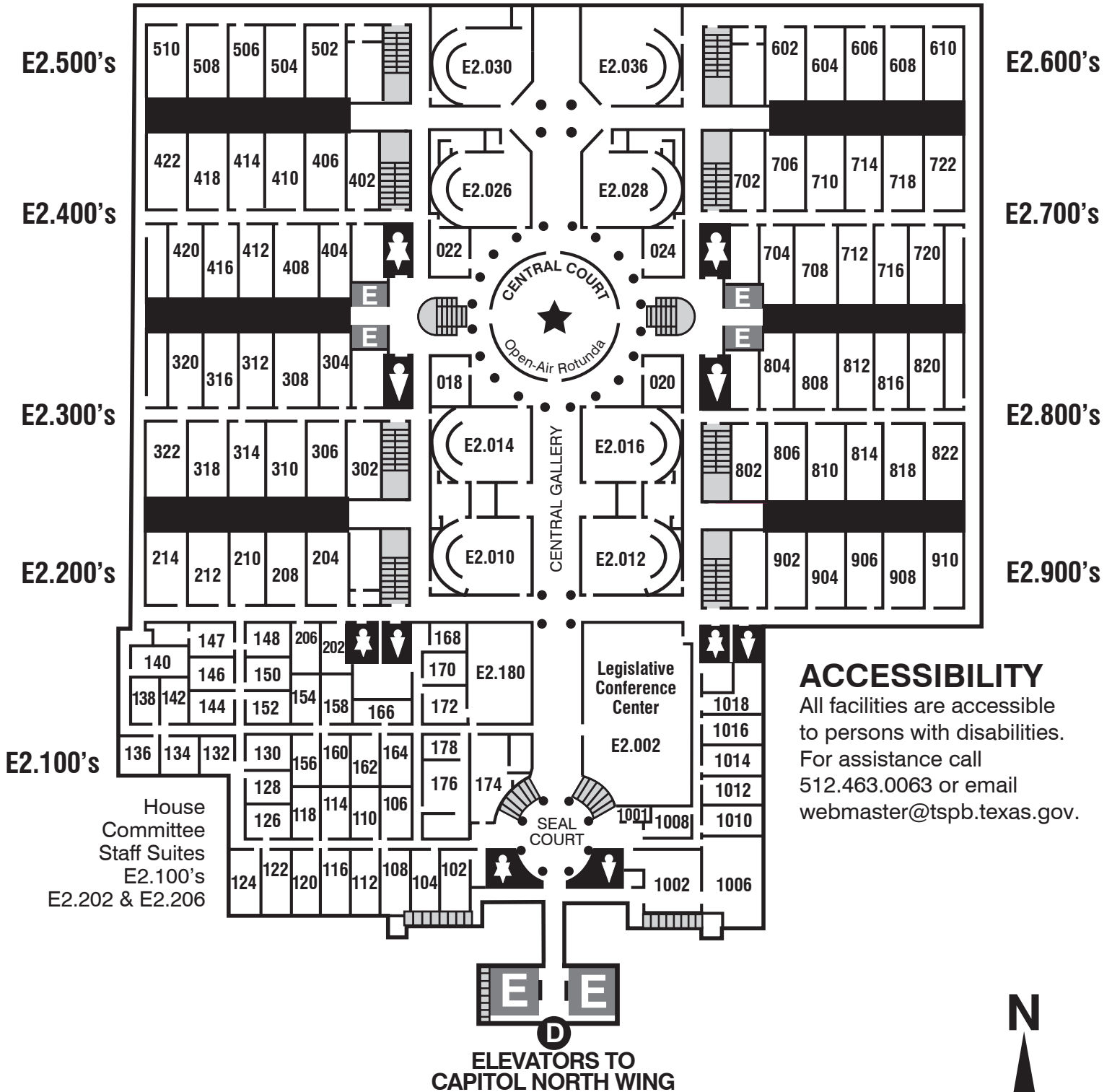

**ACCESSIBILITY**  
All facilities are accessible to persons with disabilities. For assistance call 512.463.0063 or email [webmaster@tspb.texas.gov](mailto:webmaster@tspb.texas.gov).

